



S.A.Ri.Med. Soc. Cons. a R. L.  
Servizi Assistenza Ricognizione Mar Mediterraneo

Nave sps da ricerca oceanografica universitatis  
organizzazione campagna – scheda informativa  
(a cura del committente/noleggiatore)







S.A.R.I.Med. Soc. Com. s. r. l.  
Servizi Assistenza Ricognizione Mar Mediterraneo





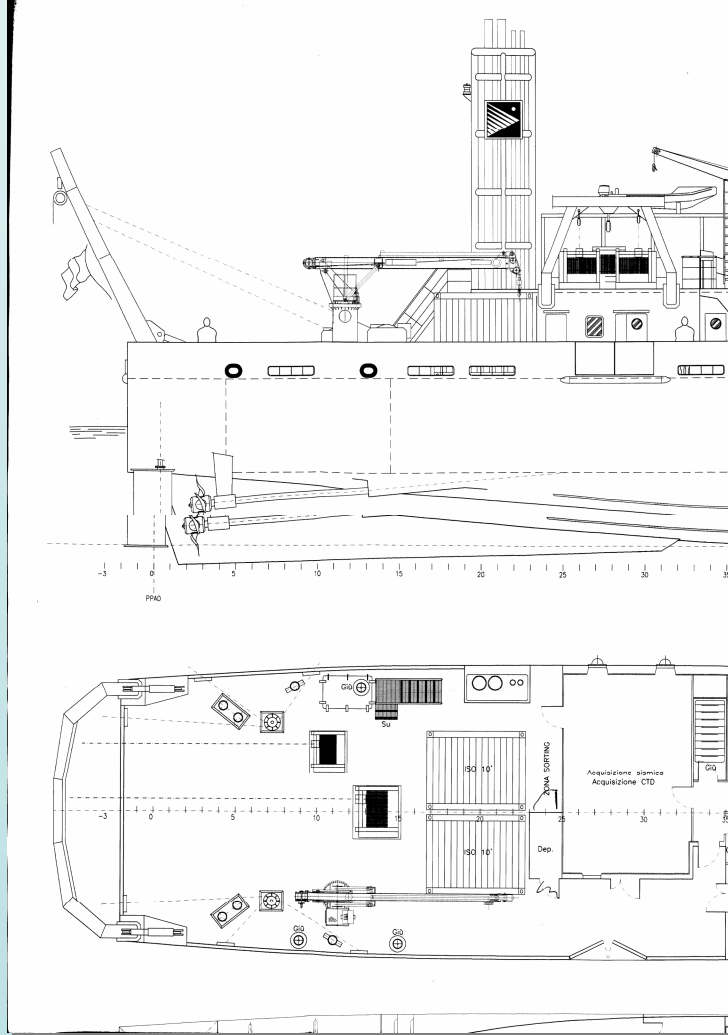

*Ponte Coperta*

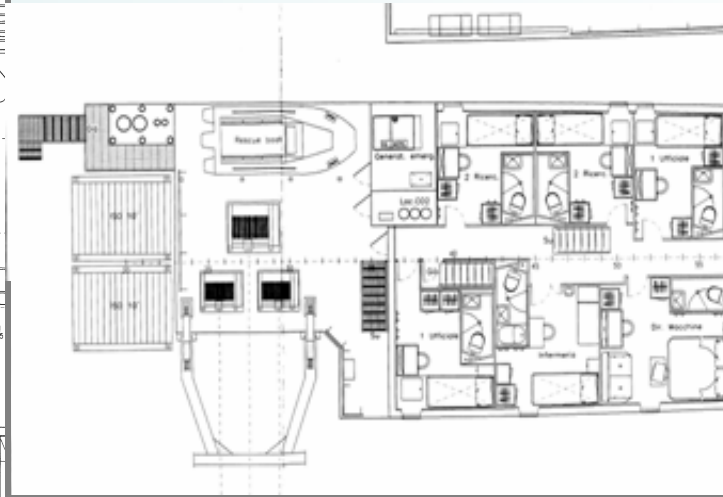

*Ponte Castello*

*Vista Longitudinale*

## TECHNICAL DESCRIPTION

*Name of Ship:* "UNIVERSITATIS"  
*Flag :* ITALIA  
*Date of built:* 2002  
*Distinctive number or letters:* IZVM  
*IMO number:* 9262077  
*Operator:* S.A.Ri.Med.  
*Web site:* <http://www.conisma.it>

### **BOAT SPECIFICATION**

#### ***Main Dimension***

- Length overall: m 44.8  
- Overall Breadth: m 9.0  
- Draught: m 3.9  
- Freeboard to working deck: m 1.20

#### ***Capacities***

- Gross Tonnage: 620 T.  
- Load Displacement: 830 T.  
- Dry Cargo holds: 239 T.  
- Stabilization:

#### ***Vessel Construction and Maintenance Supervision***

- Construction Supervised by: RINa  
- Classification Society: RINa  
- Official Number: 79748  
- IMO Number: 9262077

#### ***Range Speed and Endurance***

- Range: 10.000 mn  
- Cruising Speed: 12 knots  
- Max. Speed: 13.5 knots  
- Endurance: 30 days

### **Accommodation**

- Ship's Crew: 12
- Scientists number: 17
- Air Conditioned: Yes

### **Scientific Quarters**

- Wet laboratories area : 13 m 10 m
- Dry laboratories area: 22 m
- Free working deck area: 90 m<sup>2</sup>
- Scientific HQ and proces. room : 12 m<sup>2</sup>
- Mission HQ : 5 m<sup>2</sup>
- Automated sorting room : No
- Space for container laboratories : N° 4 ISO 10
- Radioactive Isotope Work area : No
- Scientific C / W Generation : Yes
- Storage area : Refrigerated cell 4° - 20° - 8 m<sup>3</sup> tot.
- Fresh Water Storage Capacity : 60 t
- Fresh Water Generator Capacity : 4.8 t for days

### **Engineering Design Particulars**

- Hull materials: Steel
- Engines: N. 2 Caterpillar 1000 Cv
- Electrical Systems: N. 2 Scania Generator 300 KVA
- Deck Machinery

### **Oceanography**

- Winches:
  - n. 1 5000 m for coring;
  - n. 1 5000 m for dredging
  - n. 1 5000 m CTD Rosette
  - n. 1 5000 m for plancton *net*
  - n. 1 5000 m *Mulmnet* Bioness
  - n. 1 2500 m for fishery
- Gantry: 2 Sormek – 10T; heigh 7m; TCM RN80/2L  
5 T. heigh
- Crane: 5.5 T. – 4.0 T.



## **SCIENTIFIC EQUIPMENTS**

### ***CTD Aboard***

- CTD Type: SBE 911
- CTD Tow able: 5000 m
- CTD Oxygen Sensing: Yes
- CTD Transmissivit : Yes
- CTD Fluormeter: Yes
- CTD Rosette: General Oceanic
- Thermosalinograph : SBE 21

### ***Fishing Equipment***

- Fishing echosounders: Simrad EK 60 – 38 KHz
- Deep seas fishing echosounder : No

### ***Underwater Vehicle Capabilities***

- Underwater Vehicle Support: Yes
- ROV: Comex Achille M3 / M4
- AUV's:
- Submersible: NO

### ***Navigation and Positioning***

- Navigation Equipment:
- Electronic MAP: NO
- GPS: N.2 DGPS – N.1 DGPS
- Radar: N.2 Furuno
- Navigation Sounder: N.2 Furuno
- Automatic Pilot: Walker 3000 Adaptative Autopilot
- Dynamic Positioning: NO
- Meteofax Receiver: Icom ICPR 1000 – SW Radio Com 5.1

### ***Acoustic and Profiling***

- Echosounders : Simrad EA 400 – 27/200 KHz
- Sonar Type : No
- Sea Surface Mapping System : No
- Side Scanning : Klein 3000
- Multibeam : Reson sea beat 8160
- Acoustic Doppler Current: ADCP 150KHz
- Silent Ship Operations : No

### ***Other***

- Central clock:
- Weather station: Micros

### ***Diving Support***

- Diving Capabilities: Yes

### ***Communication***

- GSM: Motorola
- Radio-communication: Radio station GMDSS A1 – A2
- Satellite Communication: Fleet 77, Iridium Sailor
- Others: e-mail